

**AWWA C504  
 BUTTERFLY VALVE  
 FLANGED ENDS - CL150  
 WITH BURIED SERVICE  
 SIZES 14"-24"**

DRAWING NO.- **BD16-F11-M1110-11110** REV - 10/28/20

DRAWN BY - **CTJ** 16" valve shown here

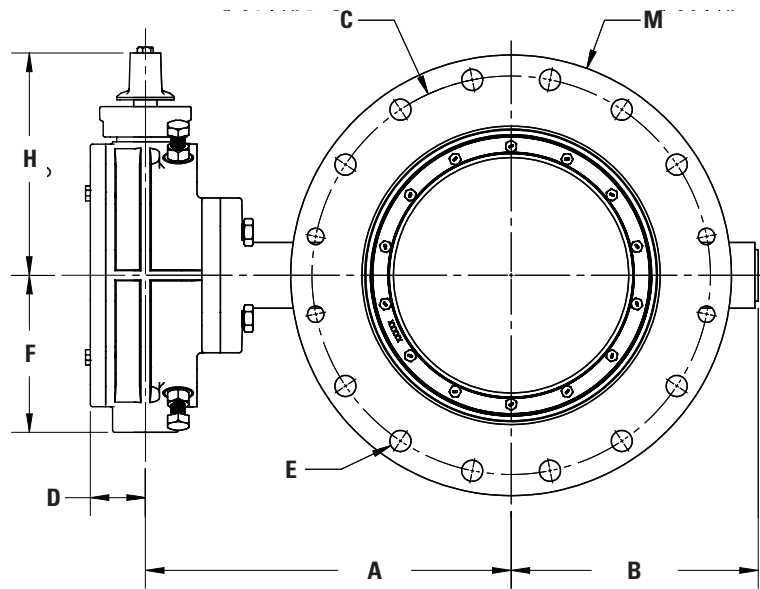

SIZE	A	B	C	D	E	F	G	H	J	K	L	M	N	P	Q	R	AA	AB	OP. FLG	WEIGHT
14"	18-3/4"	12-3/16"	18-3/4"	2-15/16"	1-1/8"	8-3/8"	3-7/8"	11-7/8"	8"	4"	1-3/8"	21"	48	12	1"	4"	4	1"-8 UNC	FA16	485 lbs.
16"	19-1/2"	13-3/16"	21-1/4"	2-15/16"	1-1/8"	8-3/8"	3-7/8"	11-7/8"	8"	4"	1-7/16"	23-1/2"	48	16	1"	4"	4	1"-8 UNC	FA16	570 lbs.
18"	20-1/4"	14-7/16"	22-3/4"	2-15/16"	1-1/4"	8-3/8"	3-7/8"	11-7/8"	8"	4"	1-9/16"	25"	48	16	1-1/8"	4"	4	1-1/8"-7 UNC	FA16	735 lbs.
20"	21-1/2"	15-7/16"	25"	2-15/16"	1-1/4"	8-3/8"	3-7/8"	11-7/8"	8"	4"	1-11/16"	27-1/2"	48	20	1-1/8"	4"	4	1-1/8"-7 UNC; 1-3/4" Min. Depth	FA16	860 lbs.
24"	24-1/8"	18-1/2"	29-1/2"	2-15/16"	1-3/8"	10-3/8"	4-3/4"	13-7/8"	8"	4"	1-7/8"	32"	72	20	1-1/4"	6"	4	1-1/4"-7 UNC	FA25	1,165 lbs.

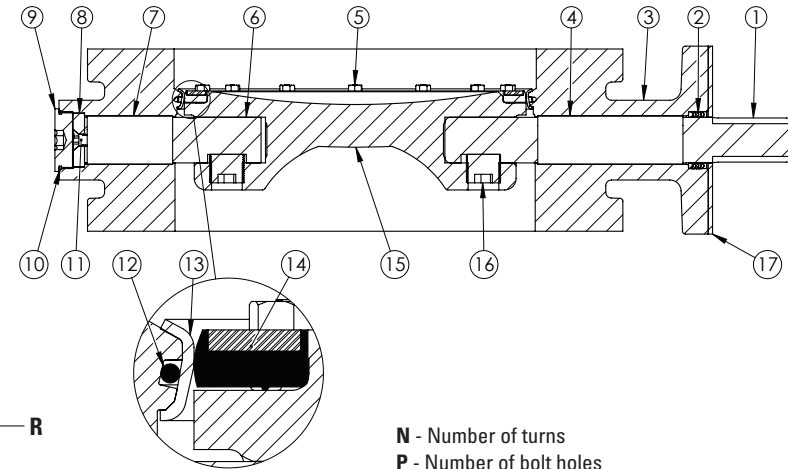

- N** - Number of turns
- P** - Number of bolt holes
- Q** - Diameter of bolts
- 1. Flow may be in either direction
- 2. Valve shaft will meet or exceed AWWA C504 requirements
- 3. Reference AWWA C504 for flanges and drilling (ANSI 125)
- 4. N turns to close
- 5. (P) E bolts on each flange
- 6. Rated for 150 PSI working pressure

SIZE	DESCRIPTION	MATERIAL
1	Operator Shaft	304 Stainless Steel, ASTM A-276
2	V-Ring Packing	EPDM & Buna-N
3	Butterfly Valve Body	Ductile Iron, ASTM A-536
4	Upper Journal Bearing	Nylatron
5	Vane Ring Hexhead Cap Screws	18-8 Stainless Steel
6	Thrust Shaft	304 Stainless Steel, ASTM A-276
7	Lower Journal Bearing	Nylatron
8	Thrust Bearing	Bronze Alloy
9	Body End Plug	Steel
10	Body End Plug O-ring	EPDM
11	Thrust Bearing Cap Screw	18-8 Stainless Steel
12	Body O-ring	EPDM
13	Body Seat Ring	316 Stainless Steel
14	Vane Seat Ring	EPDM w/ Stainless Steel Insert
15	Vane	Ductile Iron, ASTM A-536
16	Vane Shaft Torque Plug	18-8 Stainless Steel
17	Seal Plate*	Steel

\* Seal Plate must be ordered separately with all barestem valves.