



**MCWANE**  
PLANT & INDUSTRIAL

# AWWA C504 BUTTERFLY VALVE MECHANICAL JOINT ENDS - CL150 WITH BURIED SERVICE SIZES 14"-24"

DRAWING NO. - **BD16-M11-M1110-11110** REV - **10/30/20**

DRAWN BY - **CTJ** 16" valve shown here

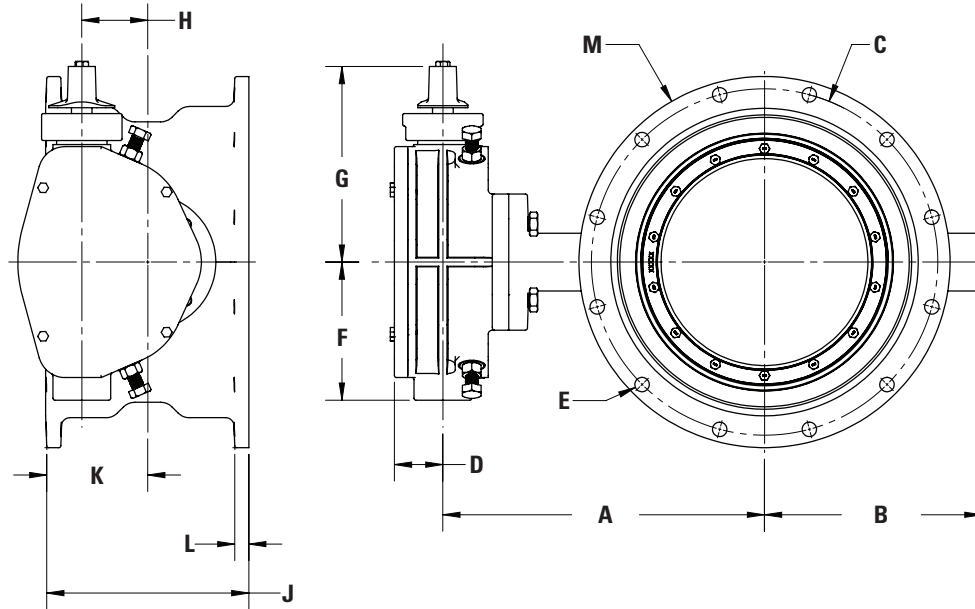
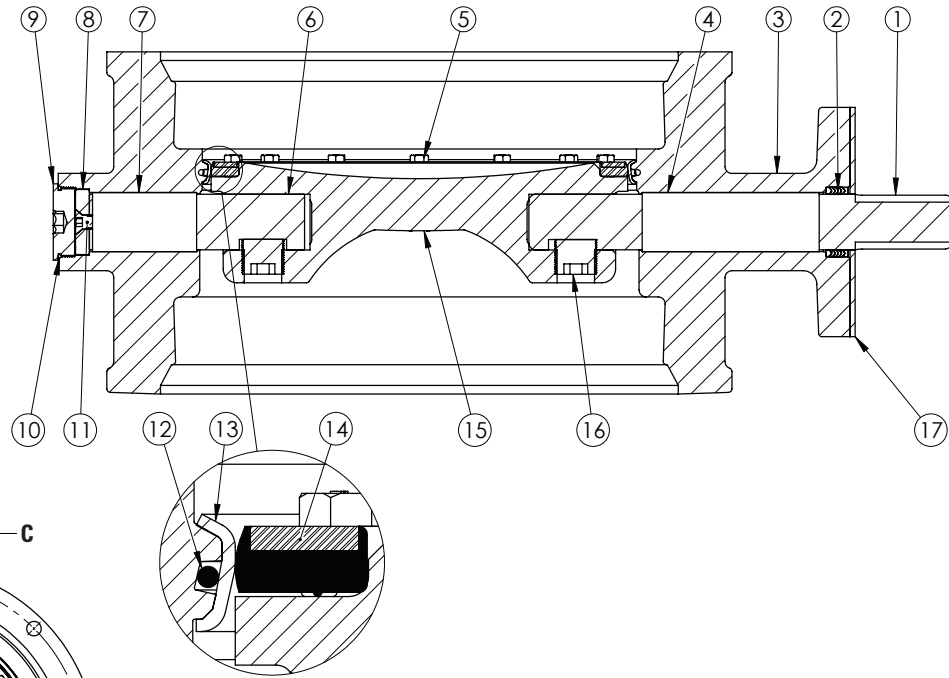

- N** - Number of turns  
**P** - Number of bolt holes  
**Q** - Diameter of bolts
1. Flow may be in either direction
  2. Valve shaft will meet or exceed AWWA C504 requirements
  3. Reference AWWA C504 for flanges and drilling (ANSI 125)
  4. N turns to close
  5. (P) E bolts on each flange
  6. Operated by 2" AWWA Operating / Wrench Nut
  7. Rated for 150 PSI working pressure
  8. Gaskets, glands, and bolts for Mechanical Joint furnished with valve when specified on order

SIZE	A	B	C	D	E	F	G	H	J	K	L	M	N	P	Q	OP. FLG	WEIGHT
14"	18-3/4"	12-3/16"	18-3/4"	2-15/16"	7/8"	8-3/8"	11-7/8"	4"	12-1/4"	4"	13/16"	20-1/4"	48	10	3/4"	FA16	580 lbs.
16"	19-1/2"	13-3/16"	21"	2-15/16"	7/8"	8-3/8"	11-7/8"	4"	12-1/4"	4"	7/8"	22-1/2"	48	12	3/4"	FA16	670 lbs.
18"	20-1/4"	14-7/16"	23-1/4"	2-15/16"	7/8"	8-3/8"	11-7/8"	4"	13-1/8"	4"	1"	24-13/16"	48	12	3/4"	FA16	920 lbs.
20"	21-1/2"	15-7/16"	25-1/2"	2-15/16"	7/8"	8-3/8"	11-7/8"	4"	13-1/8"	4"	1"	27-1/16"	48	14	3/4"	FA16	1,065 lbs.
24"	24-1/8"	18-1/2"	30"	2-15/16"	7/8"	10-3/8"	13-7/8"	6"	14-1/2"	4"	1"	31-9/16"	72	16	3/4"	FA25	1,475 lbs.

SIZE	DESCRIPTION	MATERIAL
1	Operator Shaft	304 Stainless Steel, ASTM A-276
2	V-Ring Packing	EPDM & Buna-N
3	Butterfly Valve Body	Ductile Iron, ASTM A-536
4	Upper Journal Bearing	Nylatron
5	Vane Ring Hexhead Cap Screws	18-8 Stainless Steel
6	Thrust Shaft	304 Stainless Steel, ASTM A-276
7	Lower Journal Bearing	Nylatron
8	Thrust Bearing	Bronze Alloy
9	Body End Plug	Steel
10	Body End Plug O-ring	EPDM
11	Thrust Bearing Cap Screw	18-8 Stainless Steel
12	Body O-ring	EPDM
13	Body Seat Ring	316 Stainless Steel
14	Vane Seat Ring	EPDM w/ Stainless Steel Insert
15	Vane	Ductile Iron, ASTM A-536
16	Vane Shaft Torque Plug	18-8 Stainless Steel
17	Seal Plate*	Steel

\* Seal Plate provided with all barestem valves, and used with all purchased operators.