

# KEN-FLEX™ CHECK VALVE WITH SPRINGS

16" & 24" DOMESTIC ONLY

ITEM NO.	DRAWING	DESCRIPTION	MATERIAL	QTY.
1	81783	BODY	DUCTILE IRON	1
2	32511	COVER	DUCTILE IRON	1
3	54298	FLAPPER ASSEMBLY	EPDM RUBBER	1
3.1	32339	FLAPPER DISC	DUCTILE IRON	1
3.2	54301	KENFLEX FLAPPER PIN	AISI 1020	1
4	32475	SPRING	302 STAINLESS	5
5	32480	SPRING BRACKET - 16"	STAINLESS STEEL	1
6	54299	FLAPPER SPRING PIN	304 STAINLESS	1
7	54300	COVER SPRING PIN	AISI 304	1
8	32629	SPRING SPACER (TOP)	NYLON	10
9	32630	SPRING SPACER (BOTTOM)	NYLON	10
10	-	COTTER PIN	STAINLESS STEEL	2
11	-	HHCS - 1/2" - 13 X 5/8" LG.	STAINLESS STEEL	2
12	-	HHCS - 1" - 8 X 2 - 3/4" LG.	304SS	8
13	-	PIPE PLUG - 1" NPT	STEEL	1
14	-	O-RING, SIZE -471	-	1
15	OMIT	-	-	-
16	-	WASHER - 1"	STAINLESS STEEL	8

AWWA - TESTING DETAILS	
AWWA C508	250 PSI
DESCRIPTION	TEST PRESSURE
SHELL TEST	500 PSI
SEAT TEST	250 PSI

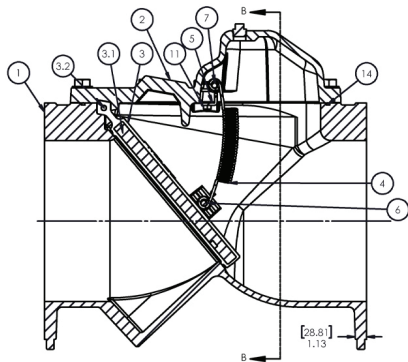
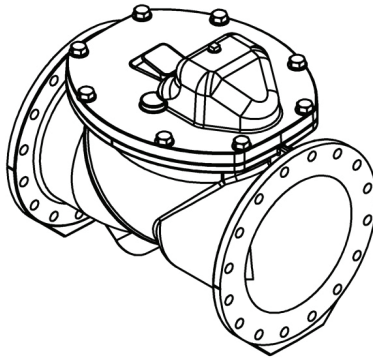
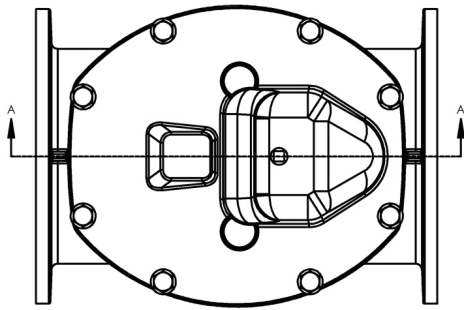

SECTION A-A

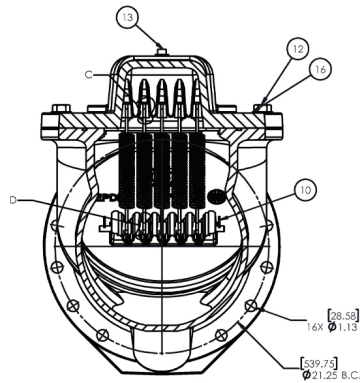

SECTION B-B

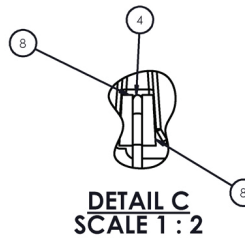

DETAIL C  
SCALE 1:2

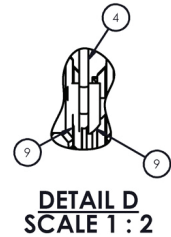

DETAIL D  
SCALE 1:2