

**AWWA C504  
BUTTERFLY VALVE  
FLANGED ENDS - CL150  
WITH BURIED SERVICE  
SIZES 3" - 12"**

DRAWING NO. - **BD06-F11-M2210-11110** REV - 7/9/21

DRAWN BY - **CM** 6" valve shown here

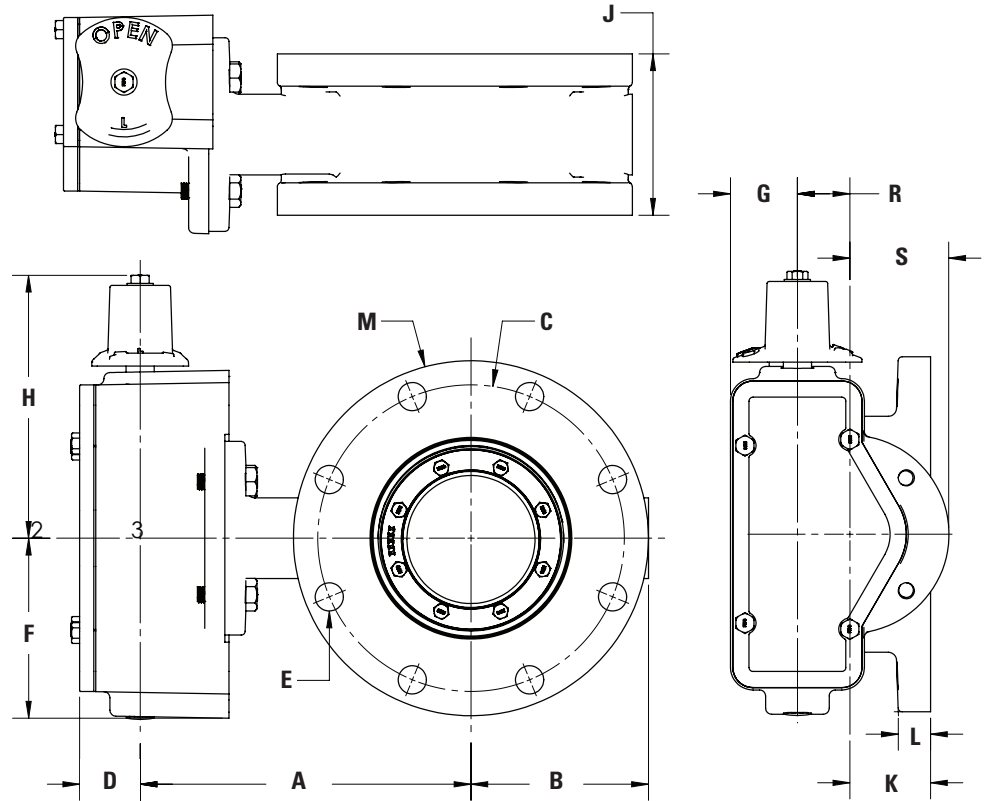
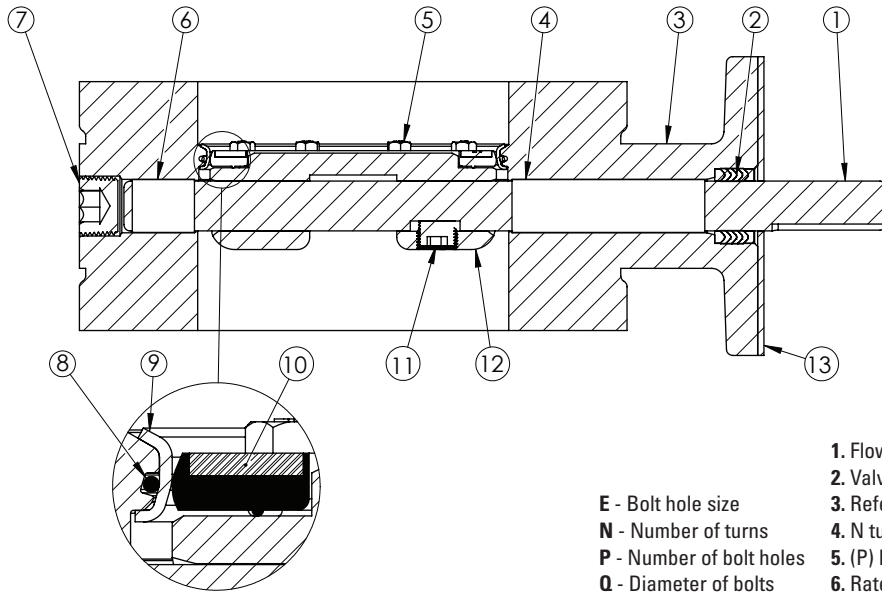

- 1. Flow may be in either direction
  - 2. Valve shaft will meet or exceed AWWA C504 requirements
  - 3. Reference AWWA C504 for flanges and drilling (ANSI 125)
  - 4. N turns to close
  - 5. (P) E bolts on each flange
  - 6. Rated for 150 PSI working pressure
- E** - Bolt hole size  
**N** - Number of turns  
**P** - Number of bolt holes  
**Q** - Diameter of bolts

SIZE	A	B	C	D	E	F	G	H	J	K	L	M	N	P	Q	R	S	OP. FLG	WEIGHT
3"	9-7/16"	4-13/16"	6"	1-7/8"	5/8"	5-9/16"	2-1/16"	8-1/8"	5"	2-1/2"	1"	9"	29	4	5/8"-11 UNC	1-5/8"	3-1/16"	FA12	75 lbs.
4"	9-7/16"	4-13/16"	7-1/2"	1-7/8"	3/4"	5-9/16"	2-1/16"	8-1/8"	5"	2-1/2"	1"	9"	29	8	5/8"	1-5/8"	3-1/16"	FA12	75 lbs.
6"	10-1/4"	5-1/2"	9-1/2"	1-7/8"	7/8"	5-9/16"	2-1/16"	8-1/8"	5"	2-1/2"	1"	11"	29	8	3/4"	1-5/8"	3-1/16"	FA12	95 lbs.
8"	13"	6-3/4"	11-3/4"	1-7/8"	7/8"	5-9/16"	2-1/16"	8-1/8"	6"	3"	1-1/8"	13-1/2"	29	8	3/4"	1-5/8"	N/A	FA12	140 lbs.
10"	13-1/4"	8-1/4"	14-1/4"	1-7/8"	1"	5-9/16"	N/A	8-1/8"	8"	4"	1-3/16"	16"	29	12	7/8"	1-5/8"	N/A	FA12	232 lbs.
12"	14-1/8"	9-1/2"	17"	1-7/8"	1"	5-9/16"	N/A	8-1/8"	8"	4"	1-1/4"	19"	29	12	7/8"	1-5/8"	N/A	FA12	300 lbs.

SIZE	DESCRIPTION	MATERIAL
1	Operator Shaft	304 Stainless Steel, ASTM A-276
2	V-Ring Packing	EPDM & Buna-N
3	Butterfly Valve Body	Ductile Iron, ASTM A-536
4	Upper Journal Bearing	Nylatron
5	Vane Ring Hexhead Cap Screws	18-8 Stainless Steel
6	Lower Journal Bearing	Nylatron
7	Body End Plug	Steel
8	Body O-ring	EPDM
9	Body Seat Ring	316 Stainless Steel
10	Vane Seat Ring	EPDM w/ Stainless Steel Insert
11	Vane Shaft Torque Plug	18-8 Stainless Steel
12	Vane	Ductile Iron, ASTM A-536
13	Seal Plate*	Steel

\* Seal Plate must be ordered separately with all barestem valves.