



KENNEDY VALVE

C509 2" - 12" RESILIENT WEDGE GATE VALVE

CERTIFICATIONS

ISO 9001

ISO 14001

BS OHSAS 18001



AWWA C509



WWW.KENNEDYVALVE.COM

Kennedy Valve revolutionized the gate valve market in the early 1980's by offering the first resilient seated gate valve in the USA. Today Kennedy is still the industry leader in UL-FM gate valve design and performance with product rated to up 350 psi for UL-FM service requirements. All 12" and down Kennedy OS&Y's come standard with a machined groove to easily accommodate adding a supervisory switch to the product.

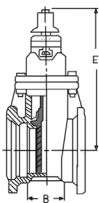

8571
Mechanical Joint
2"-12"

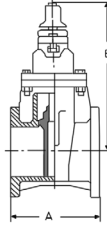

8561
Flanged
2"-12"

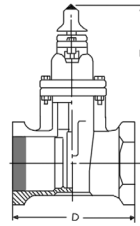

8057
Threaded Ends
2"-3"

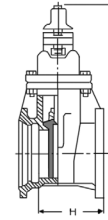

8572
Flanged x MJ
3"-12"

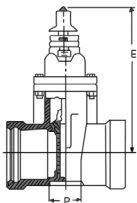

8597
Push on for
SDR PVC
2"-12"

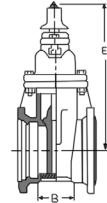

8576
Mechanical
Cutting in Joint
4"-12"

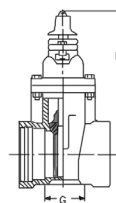

8901
Tyton Ends for Ductile Iron
and C900 PVC Pipe
4"-12"

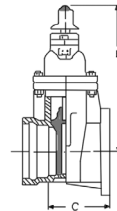

8902
Flanged x Tyton
4"-12"

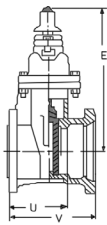

8950
Mechanical Joint
for Tapping
3"-12"

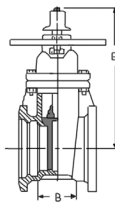

8071
Mechanical Joint
Post Indicator Valve
2"-12"

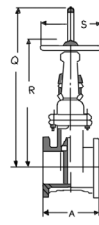

8068A
Flanged OS&Y
Construction
2"-12"

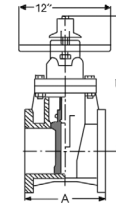

8701A
Flanged Post
Indicator Valve

Note: It is recommended that valves be installed with stems vertical when used in raw sewage or sludge applications or in water with excessive sediment. Flanged end connections not recommended for buried service.

STANDARD DIMENSIONS

VALUE SIZE	A	B	C	D	E	G	H	P	Q	R	S	U	V	# Turns to Full Open
2"	7	3-1/4		5-3/8	10-7/8			3	10	12	7-1/4			6-1/2
2-1/2"	7-1/2			7-1/8	11-3/8			3-1/4	16-3/8	13-7/8	7-1/4			8
3"	8	3-1/2		7-1/8	12-3/8		5-3/4	3-1/2	18-7/8	15-5/8	10	5-3/4	8-1/4	10
4"	9	4-1/2	6-3/4		14-3/4	4-5/8	6-3/4	4-1/2	22-3/4	18-1/4	10	6-3/4	9-1/4	13-1/2
6"	10-1/2	5-1/2	7-7/8		19	5-1/4	8	5	30-1/8	23-3/4	12	8	10-1/2	19-1/2
8"	11-1/2	8-1/8	8-1/2		22-1/2	5-5/8	9-3/4	5-1/2	37-3/4	29-1/4	14	10-3/4	13-1/4	25-1/2
10"	13	10-1/2	10		26-1/2	7	11-3/4	7	45-3/4	35-3/8	18	12-1/2	14-7/8	31-1/2
12"	14	10-3/4	11-1/4		30	8-1/2	12	8-1/2	53-1/8	40-5/8	18	12-1/2	15	37-3/4

NRS with POST PLATE

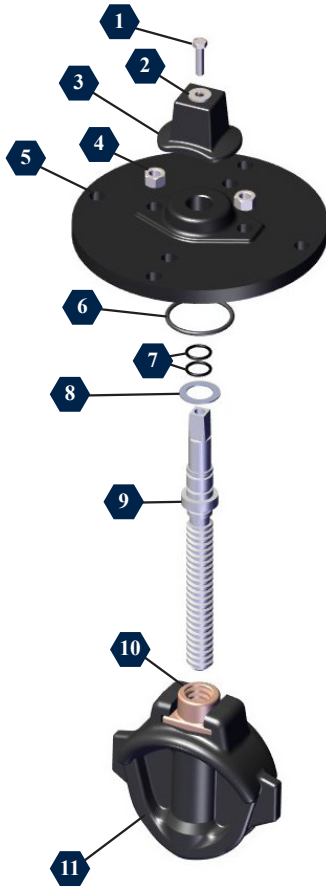

NRS

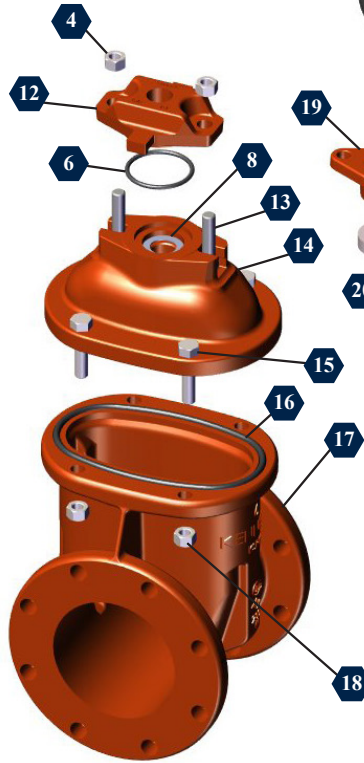

OS&Y



NO.	DESCRIPTION	MATERIAL	NO.	DESCRIPTION	MATERIAL
1	Op-Nut Bolt	Stainless Steel	17	Body	Ductile Iron
2	Op-Nut Washer	Stainless Steel	18	Cover / Body Nut	Stainless Steel
3	Op-Nut	Ductile Iron	19	Packing Gland	Ductile Iron
4	Post Plate / Stuffing Box Nut	Stainless Steel	20	Packing	Garlock Style 18
5	Post Plate	Cast Iron	21	OS&Y Wheel Nut	Bronze
6	Post Plate / Stuffing Box O-Ring	Rubber	22	Hand Wheel	Cast Iron
7	Stem O-Rings	Rubber	23	OS&Y Cover	Ductile Iron
8	Thrust Teflon Washer	Plastic	24	OS&Y Yoke Washer	Plastic
9	NRS Stem	Stainless Steel	25	OS&Y Yoke Nut	Bronze
10	NRS Stem Nut	Bronze	26	Packing Stud	Stainless Steel
11	Resilient Wedge	EPDM Encapsulated Ductile Iron	27	OS&Y Stem	Stainless Steel
12	Stuffing Box	Ductile Iron	28	OS&Y Stem O-Ring	Rubber
13	Post Plate / Stuffing Box Plate Bolt	Stainless Steel	29	OS&Y Stem Pin	Stainless Steel
14	NRS Cover	Ductile Iron	30	OS&Y Stem Head	Stainless Steel
15	Cover / Body Bolt	Stainless Steel	31	Handwheel Yoke Washer	Brass
16	Cover / Body O-Ring	Rubber			

SPECIFICATIONS & FEATURES

Kennedy Valve AWWA C509 Resilient Wedge Gate

Valves meet or exceed the requirements of AWWA standard C509, UL-262/FM-1120/1130, ULC - Underwriters' of Canada, and NSF Listed.

Available in either non-rising stem (NRS) or outside screw & yoke (OS&Y). NRS style is available with post plate for adaptation with an indicator post.



KENNEDY VALVE

	RATED PRESSURE	SEAT TEST PRESSURE	SHELL TEST PRESSURE
AWWA 2" - 48"	250 PSI	250 PSI	500 PSI
ULFM 2-1/2" - 12"	200 PSI	300 PSI	500 PSI
ULFM 14" - 16"	250 PSI	375 PSI	500 PSI
ULFM 18" - 24"	200 PSI	300 PSI	500 PSI

ORDERING INFORMATION

PH: 800-782-5831
607-734-2211
FAX: 800-952-4771

SALES@KENNEDYVALVE.COM
WWW.KENNEDYVALVE.COM

KENNEDY VALVE

1021 E. WATER ST.
ELMIRA, NY
14902-1516

- 1| 2"-12" C509 RSGV shall conform to the latest version of AWWA Standard C-509 covering Resilient Seated Gate Valves for Water Supply Service.
- 2| The valves shall have a cast iron body, and bonnet.
- 3| The wedge shall be completely encapsulated with EPDM rubber.
- 4| The sealing rubber shall be permanently bonded to the wedge to meet ASTM tests for rubber metal bond ASTM D249.
- 5| Valves shall be supplied with O-Ring seals at all joints (no gaskets are used in the valve design).
- 6| The valves shall be either non-rising or rising stem, opening by turning (left or right) and provided with 2" square operating nut or a handwheel with the "Open" and an arrow cast in the metal to indicate the direction to open.
- 7| All stems shall operate with bronze stem nuts independent of stem (in NRS valves). NRS stems shall have (2) O-Rings located above thrust collar and (1) O-Ring below. All stem O-Rings shall be replaceable with valve fully opened and subjected to full pressure. The NRS stems shall also have (2) low torque thrust bearings located above and below stem collar to reduce friction during operation.
- 8| OS&Y (rising stems) shall be of bronze. Pre-grooved stem for supervisory switch.
- 9| Waterway shall be smooth, unobstructed & free of pockets, cavities, & depressions in the seat area. Valves shall be able to accept a full size tapping cutter.
- 10| The body, bonnet, and stuffing plate shall be coated with fusion bonded epoxy. Interior surfaces to be coated as well for body & bonnet components. Epoxy shall be applied in accordance with AWWA C550 and be NSF61 and NSF372 certified.
- 11| Each valve shall have a maker's name, pressure rating, and year in which it was manufactured cast in the body. Prior to shipment from the factory, each valve shall be tested by hydrostatic pressure equal to requirements of both AWWA and UL/FM.
- 12| All internal parts shall be accessible without removing the body from the line.
- 13| Valves shall have all brass components cast and assembled in the USA and shall be manufactured by Kennedy Valve Company or equal.



For Generations